

cookworks

Mini Chopper

Model No. CH1115A



Care & Instruction Manual

For household and indoor use only

Please read these instructions before use and retain for future reference



Electrical safety

- You should only plug the appliance into a 220V-240V AC, 50Hz supply. Connecting it to other power sources may damage the appliance and will invalidate the guarantee.
- Switch off and unplug when not in use and before cleaning the appliance.
- This appliance shall not be used by children. Keep the appliance and its cord out of reach of children.
- This appliance can be used by persons with reduced physical, sensory or mental capabilities or lack of experience and knowledge if they have been given supervision or instruction concerning use of the appliance in a safe way and understand the hazards involved.
- Children shall not play with the appliance.
- Keep motor housing, cable, and plug dry and away from areas where it is likely to get splashed. Never immerse in water.
- Do not pull on the cable to disconnect from the mains supply.
- Do not operate the appliance if damaged or after it malfunctions. In the event the supply cord is damaged, in order to avoid a hazard it must only be replaced by a qualified service engineer, with a suitably approved part.
- This appliance must be positioned so that the plug is accessible and the plug socket is within easy reach of the power cord.
- Do not cover or block the ventilation holes.

Warning!

- This appliance is intended exclusively for use in domestic households. It is not suitable for commercial use.
- Always unplug the motor housing of the mini chopper if unattended and before assembling, disassembling or cleaning.
- Only use with the parts supplied and fully assembled.
- The mini chopper blades are sharp, take care when emptying the bowl and cleaning.
- Never use hot liquids in the mini chopper, always allow liquids to cool to room temperature before blending.
- Do not leave unattended during use.
- Do not exceed the quantities shown in the guideline table.
- Never place hands or utensils inside the bowl whilst the chopper is in use. Only use a scraper / spatula when the mini chopper is not in operation.
- Do not attempt to operate the mini chopper without the protective cover and bowl in place.
- Do not cover the mini chopper and allow the motor housing to cool fully before storing.
- This appliance can cause personal injury if misused.

Parts

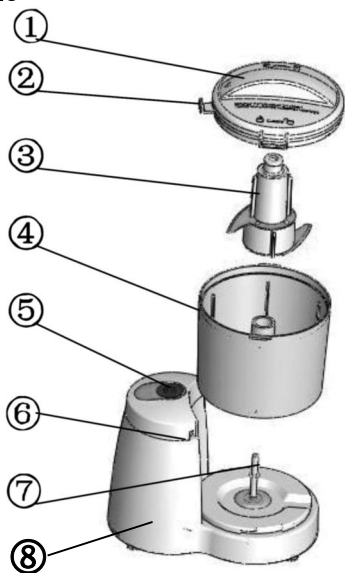

1. Lid
2. Lid locking tab
3. Blade assembly
4. Bowl
5. On/Off button
6. Lid locking slot
7. Drive shaft
8. Motor housing

IMPORTANT:

Your mini chopper is equipped with a safety feature, where the blades will not operate unless the chopper lid and chopper bowl are both correctly engaged.

To use

1. Dismantle and clean thoroughly before first use – see cleaning section.
2. Place the motor housing on a stable, flat surface.
3. Fit the bowl over the draft shaft and onto the motor housing stand. Twist the bowl clockwise until the lugs on the base are engaged with the grooves in the stand.
4. Carefully remove the plastic blade guard and place the blade assembly onto the drive shaft.
5. Prepare the food to be chopped (see maximum quantities and size of pieces in table below) and place into the bowl on top of the blades. Do not exceed the maximum quantity shown.
6. Position the lid locking tab next to the locking slot and fit the lid onto the bowl. Twist the lid clockwise until the locking tab is fully engaged. **If the bowl is not correctly locked the mini chopper will not work.**
7. Do not use without the lid in place.
8. Fully unwind the mini chopper cable and plug in.
9. Press down on the ON / OFF button to start the chopper. Chop for a **maximum** of 60 seconds. If further chopping is required, wait a few seconds before restarting.
10. To switch off, release the button and allow the blade to come to a complete stop before checking the fineness of the chop. If satisfactory, unlock the lid and remove the bowl from the motor housing.
11. After using the chopper for 3 x 60 second cycles, a short rest interval (e.g. 2 minutes) is required before using the chopper again.
12. After a total of 3 x 60 second cycles, the chopper should be rested for 20 minutes.
13. To stop or interrupt the chopping process, release the button or turn off at the mains.

Note:

- Do not run the chopper empty (without the blade covered by food).
- If using to chop fruit and vegetables, remove the skins, peel or stones and cut into small pieces before chopping. It may be necessary to add some water when chopping vegetables or fruit.

Guideline quantity

The table below is a guide to the maximum quantity of these items that should be chopped at any one time. Do not overfill the mini chopper. Most foods will only require 15 seconds to chop.

Food	Max quantity	Approx size (mm)
Nuts	100g	
Fresh herbs	30g	
Hard cheese	80g	15 x 15
Garlic cloves	150g	
Onion	150g	15 x 15
Meat	150g	15 x 15
Hard vegetables (e.g. carrots)	100g	15 x 15

Cleaning

Clean the mini chopper after each use.

1. Switch off and unplug.
2. Twist the lid anti clockwise and remove from the bowl. Carefully lift out the blade assembly and then twist the bowl anticlockwise to remove it from the stand.
3. Wipe the outside of the motor housing with a damp cloth; do not use detergent or abrasives as these may scratch the surface. Never immerse the motor housing, cable or plug in water.
4. Wash the blade assembly and other loose parts in hot water with a little washing up liquid. Rinse and wipe dry. Not suitable for dishwashers.

Technical specification

Rated voltage	220-240V AC 50/60Hz
Power consumption	120W
Class rating	2 (double insulated)
BS 1362 fuse	3A

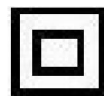



PRODUCT GUARANTEE

This product is guaranteed against manufacturing defects for a period of



Year

This product is guaranteed for twelve months from the date of original purchase.

Any defect that arises due to faulty materials or workmanship will either be replaced, refunded or repaired free of charge where possible during this period by the dealer from whom you purchased the unit.

The guarantee is subject to the following provisions:

- The guarantee does not cover accidental damage, misuse, cabinet parts, knobs or consumable items.
- The product must be correctly installed and operated in accordance with the instructions contained in this manual. A replacement copy of this instruction manual can be obtained from www.argos-support.co.uk
- It must be used solely for domestic purpose.
- The guarantee will be rendered invalid if the product is re-sold or has been damaged by inexpert repair.
- Specifications are subject to change without notice.
- The manufacturer disclaims any liability for the incidental or consequential damages.
- The guarantee is in addition to, and does not diminish your statutory or legal rights.

Guarantor: Argos Ltd
489 - 499 Avebury Boulevard
Central Milton Keynes
MK9 2NW
www.argos-support.co.uk